

Drop Off Plan  
**EISENHOWER**  
**ELEMENTARY SCHOOL**  
 DAVENPORT, IA

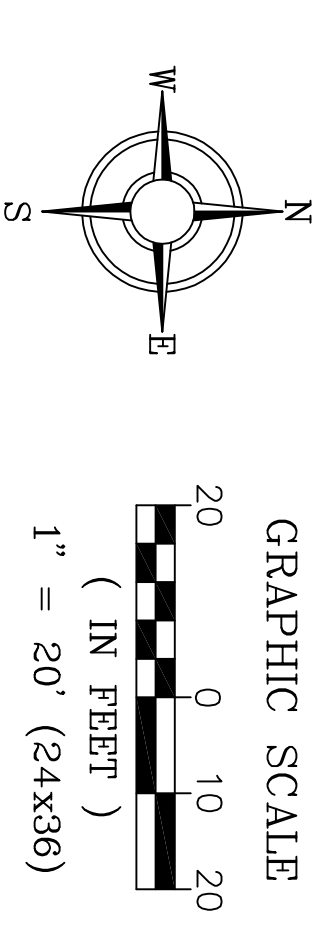

N 88°40'19"

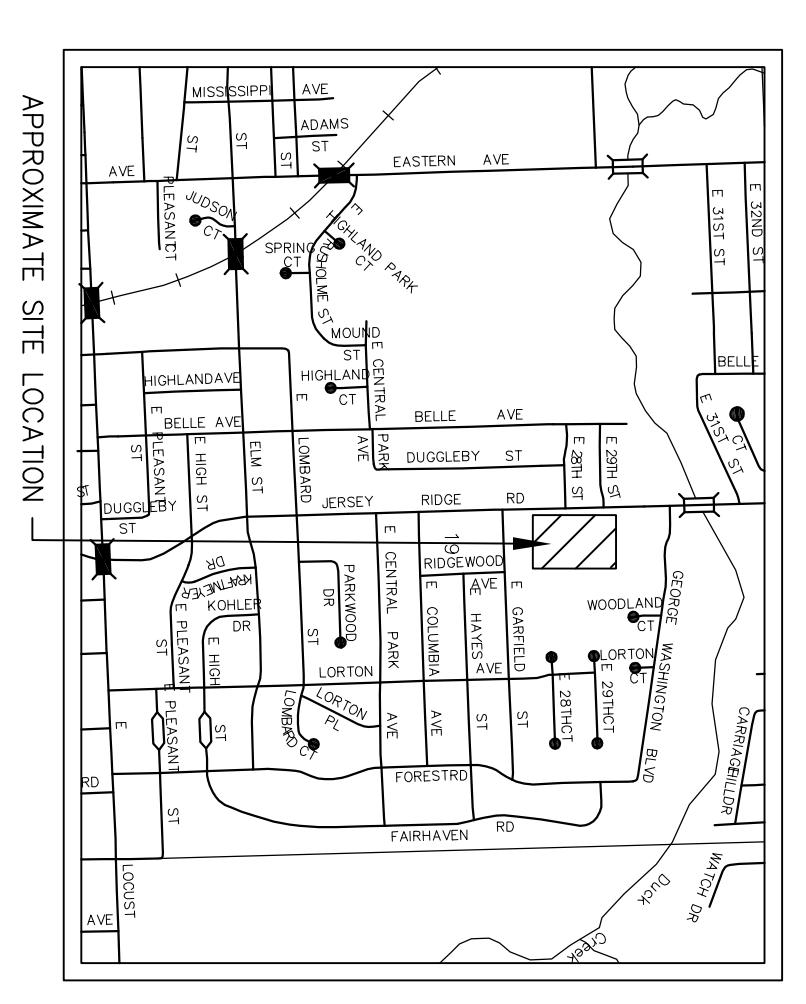

LEGEND:

- PROPERTY BOUNDARY
- EXISTING PROPERTY LINE
- EXISTING EASEMENT
- - - PROPOSED EASEMENT
- EXISTING BUILDING SETBACK
- EXISTING CENTER LINE
- EXISTING SANITARY
- EXISTING STORM SEWER
- EXISTING OVERHEAD ELECTRIC
- 399.79' MEASURED DISTANCE (200.00')
- FOUND PIN
- ⊙ STORM MANHOLE
- ⊙ SANITARY MANHOLE

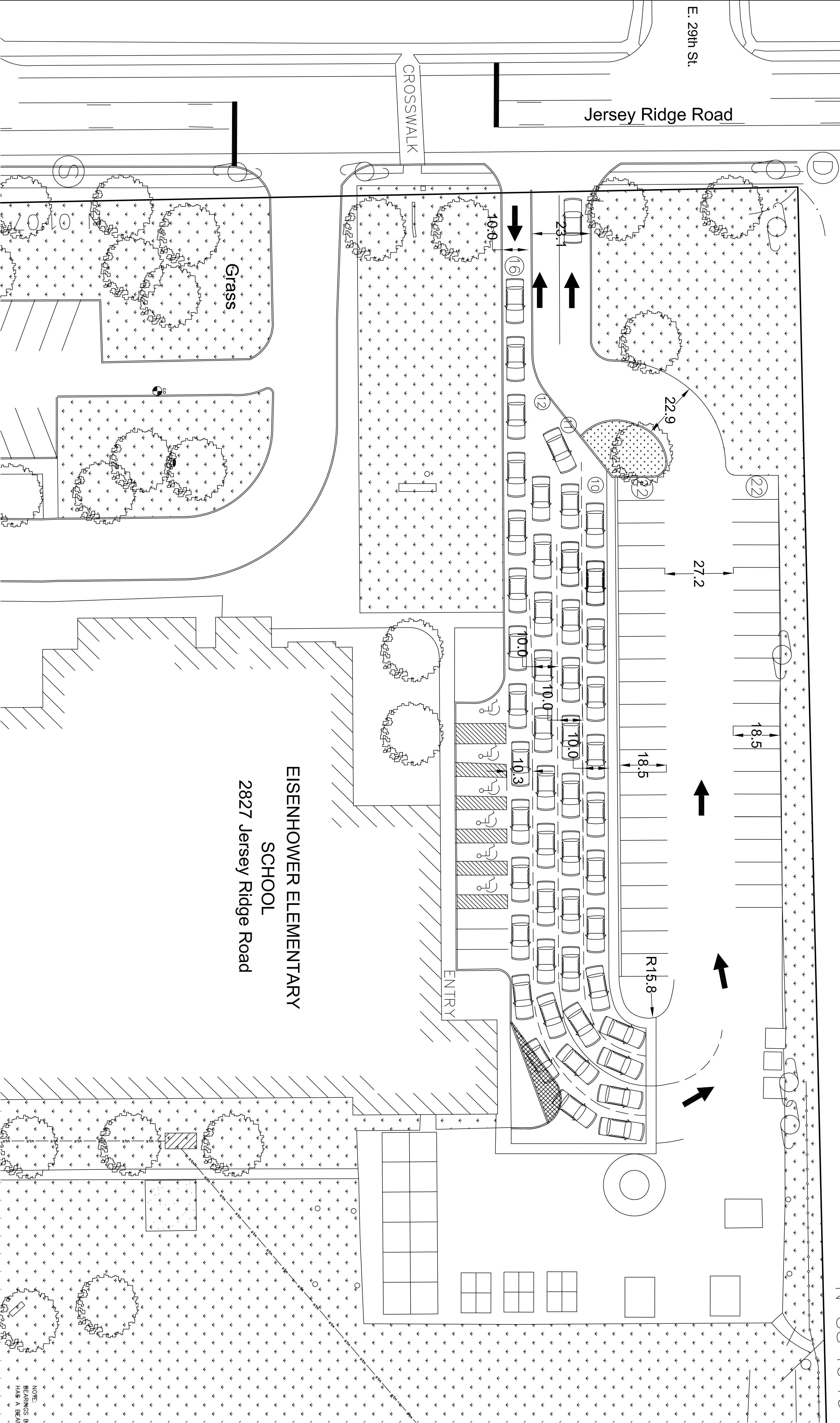

EISENHOWER ELEMENTARY  
 SCHOOL  
 2827 Jersey Ridge Road

REVISIONS:

NO.	DESCRIPTION	DATE

PROJECT: DROP OFF PLAN  
 EISENHOWER ELEMENTARY  
 DAVENPORT, IOWA

PREPARED FOR:  
 DAVENPORT COMMUNITY SCHOOLS  
 1008 WEST KIMBERLY  
 DAVENPORT, IOWA

NOTE: REFERENCE IS MADE TO THE ASSUMPTION THAT THE EASTERN PROPERTY LINE OF EISENHOWER ELEMENTARY SCHOOL IS A BEARING OF N00°27'14"W FOUND IN THE FINAL PLAN OF LANTON MEADOWS SUBD. NO. 18629-74